

Resource Area Furniture Replacement (#5)

By the Outdoor Center

Contact Information

Project Title: Resource Area Furniture Replacement	
Department: Outdoor Center	Advisor: Fred Collins
Contact Name: Angela Tsui	Contact phone: (206) 883-3788
Alt Contact Name: Fred Collins	Alt Contact Phone: x3731

Brief overview of what you would like to accomplish with a proposal?

The goal of this proposal is to improve the space of the Outdoor Center Resource Area, by making the space more inviting and multi functional through replacing the current furniture with furniture that better meets our needs.

What do you anticipate as the impact this project would have on your department?

By replacing the current existing furniture with more modular furniture that is designed to be multi functional, the space will better serve student needs by being able to accommodate a range of uses, from small groups and individuals using resource materials to larger group meetings such as pre-trip meetings and staff meetings.

What are other alternatives if your proposal is not accepted?

If this proposal is not accepted we will continue to operate with the current furniture and resubmit this proposal the next time facilities and services proposals are being considered.

Estimated Cost and timeline (Determined by VU Facilities)

Estimated costs are \$6,639.92 including tax and delivery. Timeline for delivery is typically 6-8 weeks after ordering and the ordering process can take anywhere from a week to a month.

Selection Criteria

- Makes a positive impact on WWU students or AS Service Delivery
- Has a reasonable & realistic impact on service delivery

Concept A

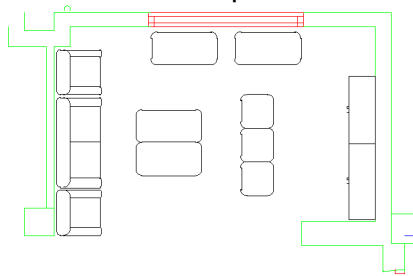

oc Lounge Purposal					
FURNITURE					
Item	Style Number	List Price	Quantity	Sum	WWU Price (Est)
Await Bench, One Section Grade 10 Fabric: Steelcase Brisa Truffle BR04	461-IB	\$ 1,266.00	4	\$ 5,064.00	\$ 2,278.80
Await Ottoman/Mobile Fabric: Steelcase Brisa Truffle BR04	460-H	\$ 694.00	4	\$ 2,776.00	\$ 1,249.20
Coupe Loveseat Aluminum Legs Fabric: Steelcase Brisa Truffle BR04	470-2	\$ 2,148.00	1	\$ 2,148.00	\$ 966.60
Coupe Chairw/Aluminum Legs Fabric: Steelcase Brisa Truffle BR04	470	\$ 1,470.00	2	\$ 2,940.00	\$ 1,323.00
Sub Total				\$ 12,928.00	\$ 5,817.60
Delivery/Install					
Tax				\$ 1,124.74	\$ 506.13
Furniture Contingency					\$ 316.19
Space prep for installation /cleanup costs (patch and paint)					
Furniture Total (est)					\$6,639.92